

ATTACHMENT A

STAVE FALLS ELEMENTARY - 30204 BRACKLEY AVE



Parcel Identifier: 018-017-789
Legal Description: Lot 1 Section 23 Township 15 NWD Plan LMP7616

The school was originally constructed in 1994 and is 1,910 sq. m.
The site is 3.8 hectares.
It has been closed since June 2008 and is currently vacant

DURIEU ELEMENTARY - 11620 SEUX ROAD

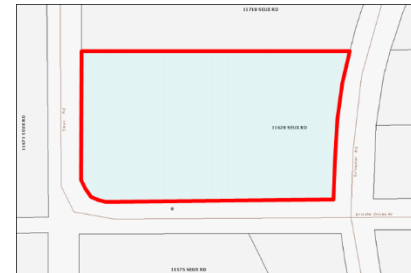

Parcel Identifier: 013-218-708
Legal Description: Lot 13 Section 13 Township 18 NWD Plan 63018

The school was originally constructed in 1982 and is 1,220 sq. m.
The site area is 2.0 hectares.
It has been closed since June 2011 and is currently leased.

ATTACHMENT A

CADE BARR ELEMENTARY - 33447 DEWDNEY TRUNK ROAD

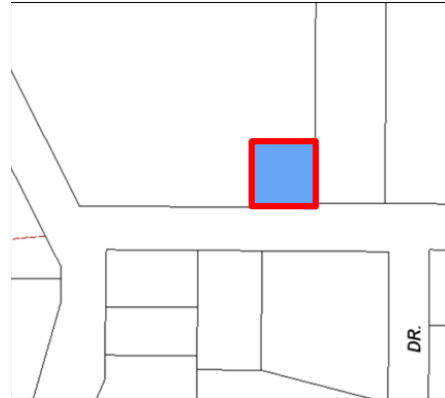

Parcel Identifier: 012-547-565
Legal Description: Parcel A (Explanatory Plan 10535) Lot 1, Section 28, Township 17 NWD Plan 2184

The school was originally constructed in 1950 and is 130 sq. m.
The parcel size is 0.1 hectare
It has been closed for several years.
This building is currently leased and used as a daycare.

NICOMEN ISLAND SCHOOL - 40071 NICOMEN ISLAND TRUNK ROAD



Parcel Identifier: 009-023-623
Legal Description: Lot 4, DL 474 Group 1 and of Section 36 Township 20 NWD Plan 29588

This building was originally constructed in 1916 and is 416 sq. m.
The parcel size is 1.2 hectares.
The school has been closed for several years and the building is currently vacant.
The land is within the Agricultural Land Reserve (ALR).